



TRC

TECHNO RUBBER COMPANY



Follow us on:



PRODUCT GUIDE

WWW.TECHNOEPDM.CO.UK



WHY CHOOSE TECHNO EPDM?

With over 15 years' experience in EPDM manufacturing, TRC – Techno Rubber Company – has a track record of producing products with superior durability, flexibility and UV resistance.

Their plant is home to the latest cutting-edge technology, has ISO 9001 certification, and has an annual capacity far exceeding 10 million m².

Techno EPDM is suitable for domestic, commercial and industrial use and is environmentally friendly by its very nature.

Plus, it is CE (Conformité Européenne) approved and comes with a BBA (British Board of Agrément) Certificate of Conformity.



✓ QUICK & EASY INSTALLATION

Available in sheet sizes up to 12.2m in width and 30.5m in length, leading to fewer seams and reduced installation time.

✓ DURABILITY & LONGEVITY

Offers unrivalled resistance to ozone, UV radiation, extreme temperatures and ageing.

✓ LOW LIFE-CYCLE COST

Requires little or no maintenance and is inherently durable, resulting in a significantly lower lifecycle cost.

✓ HIGH LEVEL OF FLEXIBILITY

Remains highly flexible, even at temperatures as low as -45°C.

TYPICAL COLD ROOF INSTALLATION

1. Strip the existing roof back to bare decking or overboard with new ply or OSB



2. Remove arris rails from open edges and fix 2" x 1" timber batten to perimeter



3. Lay membrane in the correct position and allow to relax for 20 minutes



4. Fold one half of the membrane back and, after stirring, roller apply water based adhesive to the deck. Repeat on the other half of the roof and sweep out any air bubbles



5. Thinly apply contact adhesive to both membrane and upstand. Allow to dry, then mate together



6. Use primer and 9" flashing tape to seal where the roof corners about the building



7. Fix Techno trims to the roof perimeter with matching corners and joiners, using the colour coded polynails



8. Install wall trim to rear



WHAT ABOUT WARM ROOFS?

To comply with changing regulations, roofs may need to be insulated. Use a foil-backed insulation and overboard with OSB or plywood, screwed to the deck. The membrane can then be adhered to the timber. Perimeter fascias may need to be replaced due to the finished deck height being raised.

COMMON DETAILS

Joining membrane

Use primer and 3" splice tape.

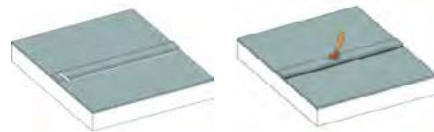

External corners

For skylights or chimneys, for example. Use primer and 9" flashing tape.

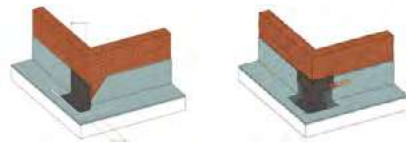

Adjoining slates or tiles

Remove bottom courses of tiles, lift underfelt and adhere membrane to the layboard with contact adhesive. Reinstall underfelt and tiles.

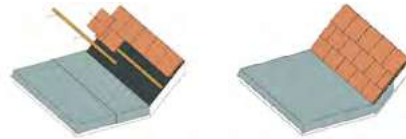

Vent pipes

Use primer and preformed pipe boot for pipes up to 6" in diameter.

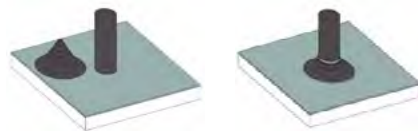

Rainwater outlet

Lay membrane over downpipe, cut aperture, insert spigot and secure with fixings. Apply primer and seal with 9" flashing tape.

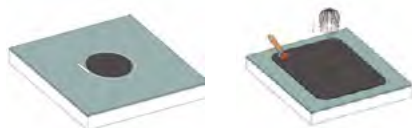

Joining felt roof

Overlap onto adjacent roof with termination bar and water block.



Parapet

Dress the membrane up and over the parapet and stick with contact adhesive. Then install a coping stone bedded on mortar or use a Techno trim to the outer elevation.



Draining onto slates or tiles

Dress membrane onto tiles by approx 5", secure 9" lead, in 1m lengths through the membrane, 3" on the deck and 6" on to the tiles. Seal the lead with primer and 6" cover tape.

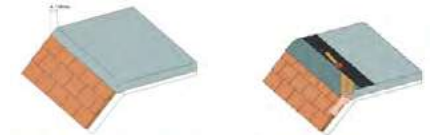

Thru-Wall outlet/scupper

Use primer and 9" flashing tape to seal.

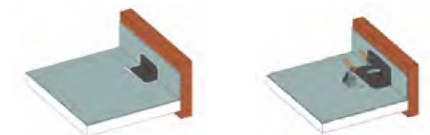

Rooflight

Cut membrane from corner to opposite corner. Use 9" flashing tape and primer to seal the corners.

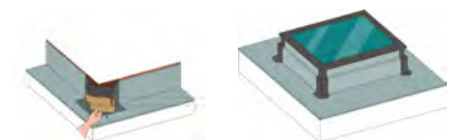

RUBBA TRIM

EDGE TRIM

- One piece
- Pre-drilled and foamed
- Supplied with fixings and joiner
- 2500mm long

GUTTER TRIM

- Two piece
- Pre-drilled
- Supplied with fixings and joiner
- 2500mm long

CORNERS

- 90° external and internal corners for edge trims
- 90° external corners for gutter trims



Available in black, white and anthracite



A CLOSER LOOK

EDGE TRIM

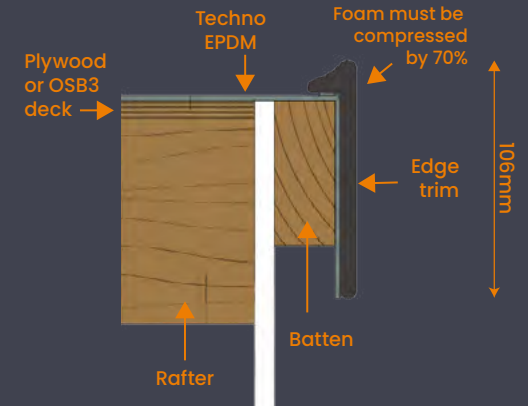

GUTTER TRIM

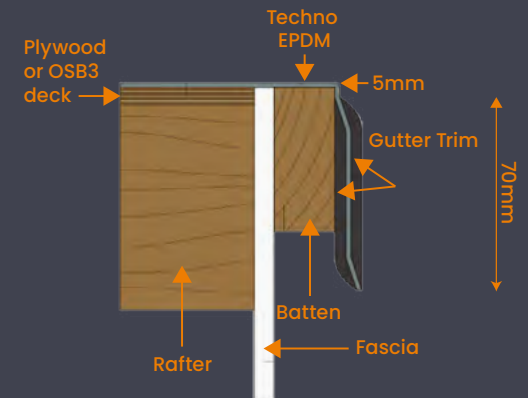



Built to perform. Backed to last.

TRC Fleece Backed EPDM, a high performance fleece backed roofing solution that saves time, reduces waste, and delivers long lasting results. Perfect for residential, commercial and industrial buildings.

It comprises an EPDM membrane which is laminated to a tough polyester reinforcement layer, significantly increasing its durability and water tight qualities.

Featuring a non fleece edge with a 75mm splice tape preinstalled.



1.5m x 15.25m



3.05m x 15.25m

Fully Adhered System

Use water based or spray applied contact adhesive to install directly onto timber or other substrates.

Long Life Expectancy

Backed by a 50 year life expectancy and 25 year warranty, it's a long term solution your customers can trust.

Time & Cost Savings

No need to strip off existing felt or fibreglass roofs – overlay directly and save on labour and disposal costs.

Wide Roll = Less Waste

Available in 1.52m or 3.05m widths.

Safe & Certified

Cold-applied, no hot works required, and fully BROOF(t4) fire rated.

Versatile Performance

Handles surface imperfections with ease – ideal for uneven substrates or refurb projects.



EPDM MEMBRANES



ADHESIVES, PRIMERS AND SEALANTS



Cut to Size TRC EPDM Membrane - 1.2mm

SKU: T045

Available sizes: Roll sizes from 3.05m x 30.5m to 12.2m x 30.5m.

Weight: 1.63kg / m²

20 year membrane warranty.

Standard grade.



Cut to Size TRC EPDM Membrane - 1.52mm

SKU: T060

Available sizes: Roll sizes from 3.05m x 30.5m to 12.2m x 30.5m.

Weight: 2kg / m²

20 year membrane warranty.

Heavy duty.



TRC Fleece Backed EPDM Roll - 2.6mm

SKU: TF0451.5M

1.5m x 15.25m.

Weight: 51.52kg / roll

A high-performance roofing membrane, perfect for a wide range of flat-roof areas.



TRC Fleece Backed EPDM Roll - 2.6mm

SKU: TF0453M

3.05 m x 15.25m.

Weight: 103.35kg / roll

25 year membrane warranty.

A high-performance roofing membrane, perfect for a wide range of flat-roof areas.



TRC Waterbased Adhesive

SKU: TWBA2.5, TWBA5, TWBA10, TWBA20

Used for adhering membrane to ply or OSB board on flat or gently sloping roofs.

Approx coverage: 3 – 4m² per litre.

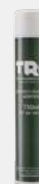

TRC Spray Contact Adhesive 750ml

SKU: TCA0.75

A spray contact adhesive used for adhering EPDM to vertical surfaces.

Approx coverage: 750ml – 2m².



TRC Contact Adhesive

SKU: TCA2.5, TCA5

Used for adhering EPDM membranes to upstands, masonry and vertical surfaces.

Approx coverage: 2 – 3m² per litre.



TRC Spray Contact Adhesive

SKU: TCA22

Sprayable contact adhesive for bonding TRC EPDM. Supplied in pressurised canister.

Approx coverage: 22 litre – 80 to 100m² (two-side application). Gun and hose not included.



TRC Primer

SKU: TP0.25, TP1, TP5

Used with all TRC tape products. Apply with scrubber pads. Must be touch dry prior to sticking.

Approx coverage:

250ml – 7.5m of 3" splice tape or 4m of 9" flashing tape.

1 litre – 3m of 3" splice tape or 16m of 9" flashing tape.

5 litres – 150m of 3" splice tape or 80m of 9" flashing tape.

ADHESIVES, PRIMERS AND SEALANTS (CONTINUED)



TRC Fleece Waterbased Adhesive

SKU: **TFWBA5, TFWBA10, TFWBA15**

Used for adhering fleece backed membrane to ply or OSB board on flat or gently sloping roofs.

Approx coverage: 3 – 3.5m² per litre



Universal Sealant

SKU: **US**

A black, waterproof silicone, used to create long-lasting seals on chases above wall trims.

Approx coverage: 300ml and 3 linear metres per cartridge.



Water Block Sealant

SKU: **WB**

Creates a seal when used under compression for a long-lasting finish.

Approx coverage: 300ml and 3 linear metres per cartridge.



Corner Adhesive

SKU: **RTCAD**

A 50g adhesive and 200ml activator. Offering superior joint adhesion on plastics. Ideal for fixing edge/gutter corners.



TRC EPDM Cleaner 500ml

SKU: **TCLEAN**

Alcohol-based degreaser with fast evaporation properties, designed to remove TRC adhesives, sealants and other contamination.



Bonding Adhesive Spray Gun

SKU: **GUN**

Spray gun to be used with 22 litre spray canister.



Gunlance

SKU: **GUNLANCE**

Spray gun with 450mm extension lance to be used with 22 litre spray canister.



22L Bonding Adhesive Spray Hose

SKU: **HOSE**

Spray hose to be used with 22 litre spray canister.



Stirrer

SKU: **STIRRER**

For thoroughly stirring adhesive prior to use.



FLASHINGS AND SEAM TAPES

TRC Flashing Tape

SKU:

T5FT, T5FTM

5" wide, 30.5m roll or per linear metre

T9FT, T9FTM

9" wide, 15.25m roll or per linear metre

T12FT, T12FTM

12" wide, 15.25m roll or per linear metre

A flexible pressure-sensitive flashing used to seal awkward angles or details.

TRC Primer is required.



TRC 3" Seam Tape

SKU: **T3ST, T3STM**

30.5m roll or per linear metre.

For joining two pieces of EPDM with an overlap joint.

TRC Primer is required.



TRC 6" Cover Tape

SKU: **T6CT, T6CTM**

30.5m roll or per linear metre.

For sealing batten bars, lead or metal edge trims.

TRC Primer is required.

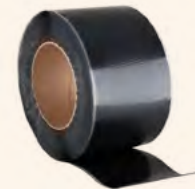

TRC Circular Corner Flashing

SKU: **TCF**

216mm

Circular piece of flashing for detail work or patching.

TRC Primer is required.



Universal Pipe Seal

SKU: **UPS**

For sealing roof protrusions from 25mm to 150mm diameter.

TRC Primer is required.



9" Detail Kit (300mm)

SKU: **DET**

1 piece 225mm by 300mm.

Flexible self adhesive 9" flashing tape for awkward angles or corners.

TRC Primer is required.



TRIMS



RubbaTrim Edge 2500mm

SKU: TET

2500mm x 106mm.

Available colours: Black, white and anthracite grey.

Used to mechanically fix membranes on exposed edges.

Raised profile designed to keep water on the roof.

All fixings and clips are supplied.



RubbaTrim Gutter 2500mm

SKU: TGT

2500mm x 70mm.

Available colours: Black, white and anthracite grey.

Used to mechanically fix the membrane on the gutter side

and allow water to drain over.

All fixings and clips are supplied.



Wall Trim

SKU: WT

2500mm long x 70mm deep x 30mm return.

Used as a cover flashing to mechanically fix EPDM to brickwork elevations. Complete with fixings.



Termination Bar

SKU: TB

2500mm.

Used for fixing membrane to masonry or upstands or adjoining felt roofs. Complete with fixings.



Black Metal Edge Trim

SKU: ET3, ET4, ET5, ET6

Available sizes: 3", 4", 5", 6" face 2500mm long.

These trims can be used as an alternative to our RubbaTrim range and are often used to terminate on the outer edge of a parapet wall instead of a coping stone.



RubbaTrim External Edge Corner

SKU: TEC

Available colours: Black, white or anthracite grey.

For 90° corners where two edge trims meet or an edge trim meets a gutter trim.

Secure with polynails or superglue.

Complete with fixings.



RubbaTrim External Gutter Corner

SKU: TGC

Available colours: Black, white or anthracite grey.

For 90° external corners where two gutter trims meet.

Secure with polynails or superglue.

Complete with fixings.



RubbaTrim Internal Edge Corner

SKU: TIC

Available colours: Black, white or anthracite grey.

For 90° corners where two edge trims meet or an edge trim meets a gutter trim.

Complete with fixings.



RubbaTrim Joiners

SKU: CLIPE, CLIPG

Available colours: Black, white or anthracite grey.

These are additional clips that can be purchased for use with edge trims and gutter trims.



Termination Bar Fixings

SKU: TBF

33 x 38mm hex head fixings c/w black cap.

DRAINS AND PIPE SEALS



Rainwater Outlet

SKU: **RWO60, RWO80, RW100**

Available sizes: 60mm / 80mm / 100mm.

For internal rainwater outlets.

Must be finished with flashing tape and TRC Primer.



Rainwater Outlet Leafguard

SKU: **LEAFGUARD**

For synthetic membrane drain outlets.



Horizontal Drain Outlet

SKU: **HD65, HD100**

Available sizes:

65mm x 100mm and 100mm x 100mm.

For thru-wall drainage.

Must be finished with flashing tape and TRC Primer.



Horizontal Drain Leafguard

SKU: **HDL**

Leafguard for use with horizontal guard outlet.

Will fit 65mm x 100mm and 100mm x 100mm.



Horizontal Spigot

SKU: **HDS65, HDS100**

Please note: 65mm x 100mm, Grey; 100mm x 100mm, Brown.

To connect to horizontal drain outlets, allowing water to disperse into a hopper or similar.

TOOLS AND ACCESSORIES



9" Roller Frame and Sleeve

SKU: **RO9**

For applying water-based adhesive to timber decks.



9" Roller Frame

SKU: **RF**



9" Roller Sleeve

SKU: **RS**



4" Roller Frame and Sleeve

SKU: **RO4**



4" Roller Sleeve

SKU: **RS4**



1.2m Roller Extension Handle

SKU: **RH**



2" Paint Brush

SKU: **PB**



7" Scissors

SKU: **SCI**



Silicone Roller

SKU: **SIL**



Double Ended Penny Roller/Silicone Roller

SKU: **PENSIL**



Penny Roller

SKU: **PEN**



Poly Nails (Box of 100) 50mm

SKU: **NAILS**

TOP ORDERING TIPS

- ✓ Order from your stockist before midday for next-day delivery
- ✓ When you order, please ensure you allow for any extra membrane to either drop into the gutter or extend up a wall or parapet
- ✓ Bear in mind that we are only able to cut rectangles or squares; no L-shapes, circles or triangles

TRC

TECHNO RUBBER COMPANY

EXCLUSIVELY DISTRIBUTED BY

AVENIR
ROOFING LTD



Follow us on:



WWW.TECHNOEPDM.CO.UK