

Katepal TopTite 6°

Self-adhesive cap sheet with SBS elastomer bitumen (1 x 8 m)

ATTENTION! TAKE CARE WHEN MOVING AROUND ON THE ROOF. READ THE INSTALLATION INSTRUCTIONS BEFORE STARTING WORK.

GENERAL INFORMATION

Katepal TopTite 6° is suitable for sealed-joint roofing applications in both new construction and reroofing projects, with a minimum roof pitch of 1:10 (approx. 6°). A pitch ratio of 1:10 means that the roof slope descends one metre over a 10-metre span. The minimum installation temperature is +5°C. When installing Katepal TopTite 6° in cold weather (below +10°C), adhesive surfaces should be warmed up with a hot air gun to ensure a good bond. If the rolls are cold, they should be stored at room temperature for one day before the installation to prevent wrinkles from forming on the surface. An underlay sheet is not needed under Katepal TopTite 6°. However, if you plan to install underlay, please follow the manufacturer's instructions for the underlay sheet.

Katepal TopTite 6° should be installed in such a way that the overlapping membrane of a joint is never on the side of the roof slope. The sheets may be installed parallel to the ridge (horizontal installation) or perpendicular to the ridge (vertical installation). We recommend vertical installation to ensure that the membranes are installed in a straight line, which avoids the risk of creasing. When installing Katepal TopTite 6° on top of existing bitumen felt roofing, the product must be installed parallel to the existing roofing so that the longitudinal joints do not coincide. The clout roofing nails must be long enough so that they penetrate through the board decking of the roof (short nails will gradually become dislodged due to the moisture expansion).

1. Valleys

If the roof has valleys, first install Katepal underlay in the valleys. Nail the sheet to the substrate from its sides at 20 cm intervals, then install drip edges along the eaves as instructed in Section 2 (we also recommend installing drip edges at the verges).

Next, lay a 50 cm wide strip of Katepal TopTite 6° along the valley. Nail the strip to the substrate from the edges at 10 cm intervals and glue the bottom end to the drip edge with Katepal K-36 sealing compound. The membranes covering the slope should overlap the Katepal TopTite 6° valley sheet by 15 cm and their ends should be cut parallel to the valley.

When glueing slope membranes to the valley sheet, apply a layer of the Katepal K-36 sealing compound approximately 0.5–1 mm thick to the overlap joint. Press the surfaces together carefully in order to avoid air pockets, and apply pressure until the sealant exudes from the seam. Finally, smooth out the residue using a spatula.

2. Flashings

Drip edge flashings should be installed on the lower eaves on top of the substrate. If using an underlay membrane, the drip edge flashings should be installed on top of the underlay. Fasten the flashing using a zigzag nailing pattern with roofing nails into the part of the flashing facing the roof slope, spacing the nails approximately 10 cm apart. Overlapping joints between flashings should have a 5 cm overlap, and each joint should be fastened with two nails through both sheets into the substrate. Gable eaves can also be flashed in the same way using drip edge flashings (Figure 2a).

If a raised eave structure is used on the gable ends, the gable flashings should be installed last, after the cap sheet has been laid. Alternative installation options are shown in Figures 2b and 2c. If a roofing underlay is used, alternative 2d should be followed.

3a. Eaves, horizontal installation

Align the edge of the Katepal TopTite 6° sheet with the eave so that the adhesive strip on the underside covers the upper side of the flashing. In order to avoid creasing, it is important to always install Katepal TopTite 6° sheets in a straight line even if the eave line is not perfectly straight. At the verges, the ends of the roofing sheets should be glued to the metal drip edge or the roof board decking with Katepal K-36 sealing compound to a width of approx. 15 cm and at a thickness of 0.5–1 mm. **NOTE: Only remove the protective film on the top surface after aligning the next sheet.**

3b. Eaves, vertical installation

Align the edge of the Katepal TopTite 6° sheet with the verge so that the adhesive strip on the underside of the sheet becomes fixed to the drip edge. If no drip edge is installed, fold the edge of the Katepal TopTite 6° sheet over the blocking piece along the verge and 1–2 cm below the underside of the roof board decking. The membrane is bonded to the blocking piece and secured by nailing it to the outer edge of the verge. Once the installation of Katepal TopTite 6° has progressed to the second gable end, bond the edge of the last sheet to the verge flashing or the roof deck with Katepal K-36 sealing compound

to a width of approx. 15 cm. At the eaves, the ends of the roofing sheets are bonded to the metal drip edge with Katepal K-36 sealing compound. In all cases the Katepal K-36 sealing compound should be applied at a thickness of 0.5–1 mm. As with horizontal installation, you must ensure that the roofing sheets are laid in a straight line to avoid creasing. **NOTE: Only remove the protective film on the top surface after aligning the next sheet.**

4. Aligning and fixing

Begin the installation of Katepal TopTite 6° by aligning the first sheet with the eave or the verge, depending on the direction of installation, and lay it in a perfectly straight line. Pre-nail the upper edge (or the inward-facing edge in the case of vertical installation) at approx. 1 m intervals through the protective film of the adhesive strip while ensuring that the sheet is kept sufficiently tight. Remove the protective film on the underside of the sheet and press the adhesive edge against the metal drip edge, ensuring that the sheet is kept sufficiently tight. Align the next sheet over the adhesive edge of the previous sheet and pre-nail the sheet in the same way as the first one. Then fold the free edge of the sheet away from the top of the adhesive edge of the previous sheet. Remove the protective film from the pre-nailed edge and nail it to the roof decking along the middle of the adhesive strip at approx. 10 cm intervals. After this, remove the protective film on the lower edge of the upper sheet and press the adhesive strips together. Ensure that the overlapping sheet is laid sufficiently tight and in a straight line. Continue installation in the same manner up to the ridge or until reaching the opposite end. In this way nails always remain concealed and there are no nail heads visible on the finished roofing.

5. TopTite 6° joints for lengthwise extension

TopTite 6° joints for lengthwise extension are made with 15 cm overlaps. Cut a triangular piece from the corner of each sheet (at the verge from the one that is between the sheets) and nail the end of the underlapping sheet to the roof deck. Apply a layer of Katepal K-36 sealing compound approx. 1 mm thick to the overlap joint (for example using a 4 x 4 mm notched spatula held at a 45° angle). Press the surfaces together carefully and apply pressure until the sealant exudes from the seam. Finally, smooth out the residue using the spatula. The Katepal K-36 sealing compound will harden to its maximum strength in approx. two weeks. **NOTE: Only remove the protective film on the top surface after aligning the next sheet.**

6. Upturns and chimneys

Once the roofing work has progressed to the upper edge of a chimney or other large penetration, cut the upturns from a sheet of Katepal TopTite 6° according to Fig. 6 and glue them with Katepal K-36 sealing compound in the numbered order over their full width to the chimney and over the roofing

sheets on the slope (15 cm overlap). Before installing the upturn pieces, install a triangular batten at the joint of the chimney and roof decking. Always make the actual upturn out of a separate strip of Katepal TopTite 6° that extends at least 30 cm above the roof surface and 15 cm over the roof slope sheets. Attach the top edge of the upturn to the chimney, for example, by nailing it to the brickwork joints. Be sure to seal the corners carefully with Katepal K-36 sealing compound. Finally, protect the upturn with sheet metal apron flashing.

7. Flue pipes

With flue pipes and similar components penetrating the roofing, use adequate pass-throughs. Install the pass-through and nail it to the roof deck through the flange. Cut a hole the size of the pass-through in the Katepal TopTite 6° sheet and bond the underlapping sheet to the flange with a 0.5–1 mm layer of Katepal K-36 sealing compound over its entire area. Attach the sheets as instructed in section 5 (extension).

8. Enhanced Ventilation

If there is a need to enhance the ventilation of the roof space, install a underpressure vent on or near the ridge of the roof. Install the vent as instructed in section 7 of these instructions.

9. Ridge

For horizontal installation, when installing roofing on the first slope, extend the Katepal TopTite 6° sheet slightly over the ridge and nail it to the roof decking. From the opposite slope, extend the sheets 20 cm over the ridge and glue them with Katepal K-36 sealing compound to the underlapping sheet, ensuring a bonding width of 15 cm and a compound thickness of 0.5–1 mm. Cut away any exposed adhesive strip left on the top surface.

For vertical installation, cut the membranes on both slopes at the ridge and glue a 30 cm wide strip of TopTite 6° over the ridge using Katepal K-36 sealing compound.

FINISHING THE ROOFING

Ensure the watertightness of the following critical areas with Katepal K-36 sealing compound:

- edges of upturns
- penetration abutments
- corners and joints of upturns around chimneys and other components
- edges of sheet extension joints.

The final step is to install flashing.

Detailed installation instructions can also be found at www.katepal.net

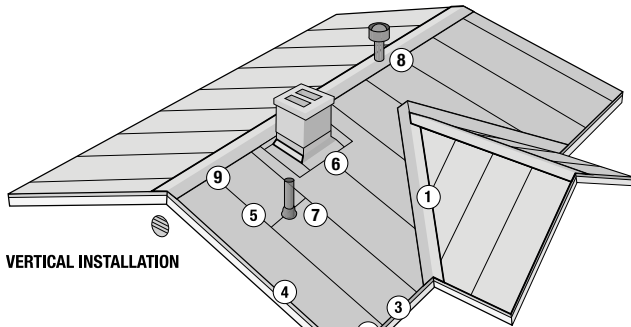

VERTICAL INSTALLATION

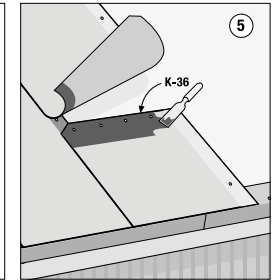
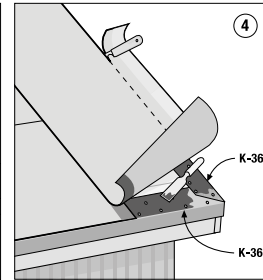
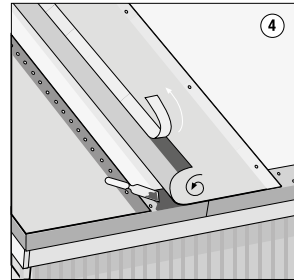
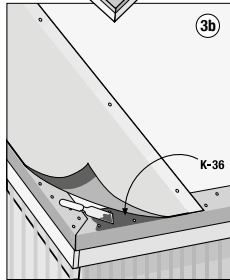
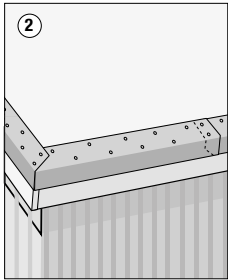
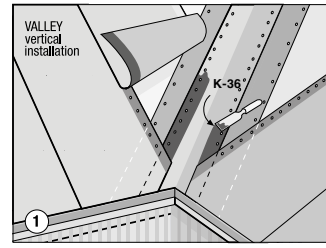
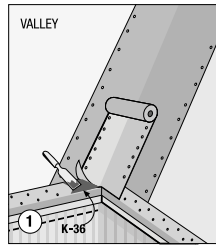

2 CONSTRUCTION OPTIONS FOR THE BLOCKING PIECE

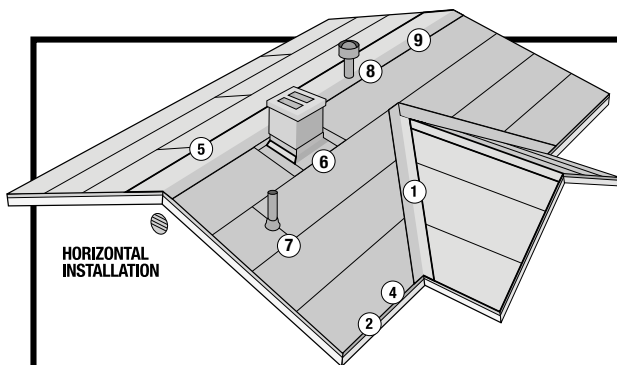
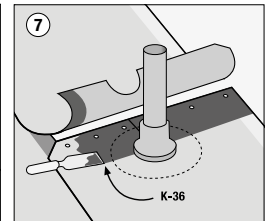
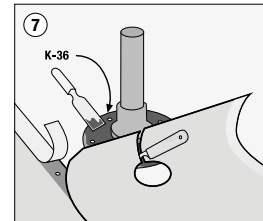
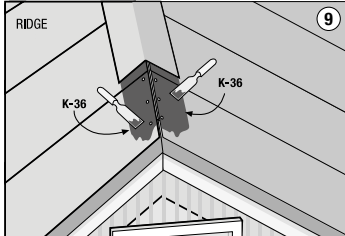
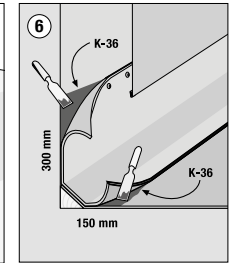
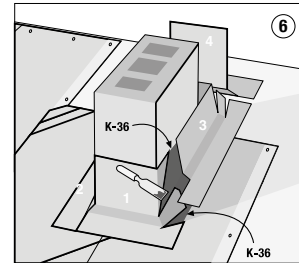
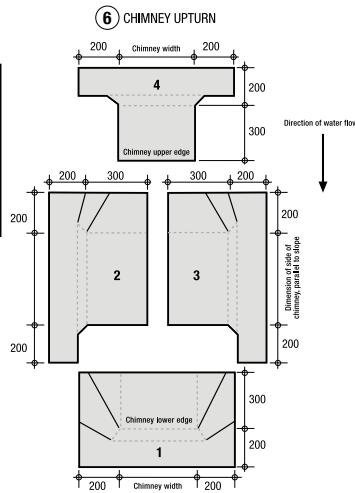
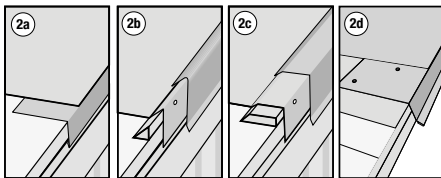

HORIZONTAL INSTALLATION

