

# FYP-V proSky, FYU-V proSky, FYW-V proSky,

## WOODEN HIGH PIVOT ROOF WINDOW



### I. APPLICATION

	High pivot roof window
	Installed in roofs with pitches 20-65°

### II. FEATURES

	Pinewood, natural colour (FYP), white NCS S0502-Y polyurethane (FYU) or acrylic (FYW)
	TopSafe system
	V40P automatic air inlet
	Quadruple sealing system
	Universal installation system
	Warm TGI spacer
	Handle Elegant

### III. ADDITIONAL PRODUCTS USED WITH WINDOWS

<b>Flashings</b>	
	standard
	special
	combination
<b>Control</b>	
	manual
	electric
<b>Mounting accessories</b>	
	insulation sets
	linings
	auxiliary rafters
	bands
	frame extensions
<b>External accessories</b>	
	awning blinds
	roller shutters
<b>Internal accessories</b>	
	blackout blinds
	roller blinds
	standard roller shutters
	awning blinds
	pleated blinds
<b>Other accessories</b>	
	insect screen

### IV. OPTIONS

	Any shape
	Wooden profiles painted in any RAL colour or one of the five transparent colours
	External cladding elements painted in any RAL colour or manufactured to match event the most unusual roofing colours (CU, TC)
	Window with a mullion bar
	Non-standard glazing unit

### V. DECLARATION OF PERFORMANCE

Harmonized standard	EN 14351-1:2006+A1:2010
Number of Declaration of Performance	XXX/CPR/14351/xx Individual numbers of Declaration of Performance are to be found in the table with technical parameters

### VI. TECHNICAL PARAMETERS

Technical parameters	Glazing unit type							
	U3	U5	P2	P5	R1	G2	G61	standards
- Window heat transmittance coefficient Uw [W/m²K]	1,3	0,97	1,3	0,97	1,3	1,3	1,3	EN 12567-2, EN 10077
- Glazing heat transmittance coefficient Ug [W/m²K]	1,0	0,5	1,0	0,5	1,0	1,0	1,0	EN 673
- Acoustic performance Rw [dB]	32 (-1;-5)	31 (-1;-4)	35 (-1;-3)	33 (-1;-3)	38 (-1;-4)**	35 (-1;-3)	38 (-1;-4)**	EN ISO 717-1
- max. capacity of air inlet [m³/h] - 10Pa	up to 49							
- air permeability class	3							
- light permeability τv	0,76	0,73	0,75	0,63	0,75	0,40	0,40	EN 410
- solar factor g	0,53	0,53	0,52	0,48	0,51	0,23	0,23	EN 410
- permeability UV	0,26	0,28	0,01	0,01	0,02	0,01	0,01	EN 410
Number of Declaration of Performance	G20/CPR/14351/xx	G22/CPR/14351/xx	G20/CPR/14351/15	G22/CPR/14351/xx	G23/CPR/14351/xx	G21/CPR/14351/xx	-	EN 14351-1:2006+A1:2010

\* Result of FAKRO internal tests

\*\* Parameter for the window without air inlet FYP R1 , G61 (For the window FYP-V R1, G61 Rw= 34(-1;-3)

## VII. DETAILED DIMENSIONS OF FDY-V WINDOWS

Window size [cm]	Size symbol	Frame external size S x L	Distance between lining grooves		Glazing area		Glazing visible area j * k [m <sup>2</sup> ]
			p	q	j	k	
55 x 98	02	547 x 981	485	924	369	791	0.29
55 x 118	16	547 x 1181	485	1124	369	991	0.37
66 x 98	03	657 x 981	595	924	479	791	0.38
66 x 118	04	657 x 1181	595	1124	479	991	0.47
66 x 140	14	657 x 1401	595	1344	479	1211	0.58
78 x 98	05	777 x 981	715	924	599	791	0.47
78 x 118	06	777 x 1181	715	1124	599	991	0.59
78 x 140	07	777 x 1401	715	1344	599	1211	0.73
78 x 160	13	777 x 1601	715	1544	599	1411	0.85
78 x 180	40	777 x 1801	715	1744	599	1611	0.96
78 x 206	42	777 x 2061	715	2004	599	1871	1.12
94 x 98	15	937 x 981	875	924	759	791	0.60
94 x 118	08	937 x 1181	875	1124	759	991	0.75
94 x 140	09	937 x 1401	875	1344	759	1211	0.92
94 x 160	80	937 x 1601	875	1544	759	1411	1.07
94 x 180	41	937 x 1801	875	1744	759	1611	1.22
114 x 98	20	1137 x 981	1075	924	959	791	0.76
114 x 118	10	1137 x 1181	1075	1124	959	991	0.95
114 x 140	11	1137 x 1401	1075	1344	959	1211	1.16
114 x 160	50	1137 x 1601	1075	1544	959	1411	1.35
134 x 98	12	1337 x 981	1275	924	1159	791	0.92
134 x 118	18	1337 x 1181	1275	1124	1159	991	1.15
134 x 140	17	1337 x 1401	1275	1344	1159	1211	1.40

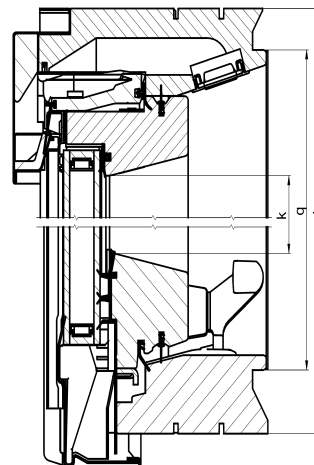
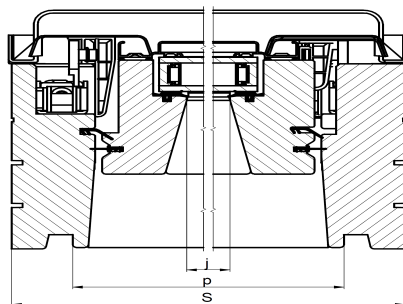

## VIII. CAPACITY OF V40P AIR INLET

		Window width [cm]					
		55/..	66/..	78/..	94/..	114/..	134/..
Geometric area * [mm <sup>2</sup> ]		2,436	3,480	4,524	4,524	6,960	6,960
<b>Pressure difference [Pa]</b>							
1	[m <sup>3</sup> /h]	5.27	6.9	8.58	8.58	14.89	14.89
	[l/s]	1.46	1.92	2.38	2.38	4.14	4.14
2	[m <sup>3</sup> /h]	7.66	10.07	12.39	12.39	21.64	21.64
	[l/s]	2.13	2.8	3.44	3.44	6.01	6.01
10	[m <sup>3</sup> /h]	17.28	23.34	27.89	27.89	49.08	49.08
	[l/s]	4.8	6.48	7.75	7.75	13.63	13.63
20	[m <sup>3</sup> /h]	16.86	30.97	34.12	34.12	70.84	70.84
	[l/s]	4.68	8.6	9.48	9.48	19.68	19.68

\* the smallest cross-section area of the air inlet channel

