



DEF DU8

ELECTRICALLY OPENED FLAT ROOF WINDOW WITH QUADRUPLE DU8 GLAZING UNIT

I. APPLICATION

Plastic window/skylight with the base intended for flat roofs.

Parameter	Value/Type	Marking
Roof angle	2° - 15°	
Roofing base type	membrane, roofing felt paper, green roofs, gravel roofs	-

IV. TECHNICAL PARAMETERS

Parameter	Unit	Value	Harmonized standard
U _w	[W/m²K]	0,64	EN 14351-1:2006+A2:2016
U _f	[W/m²K]	0,66	
Ψ	[W/mK]	0,055	
R _w	[dB]	33 (-1; -3)	
Wind load resistance		Class C5/B5 Class C2/B2*	
Snow load resistance		6H-10-4H-10-4H-12-44.2	
Resistance to fire		B-s2,d0	
Resistance to external fire		B _{roof} (t1)	
Watertightness Unshielded (A)		E1200	
Impact resistance		Class 5 – 950 mm	
Load bearing capacity of safety devices		ndp**	EN 1279-5 + A2:2010
Air permeability		Class 4	
U _g	[W/m²K]	0,4	
τ _v	[%]	49	
g	[%]	38	
Glazing unit		6 RH-Tg10Kr-4HT-Tg10Kr-4HT-Tg12Kr-44.2T	

* for windows wider or longer than 140cm

** no performance determined

II. WINDOW SET ELEMENTS

NO.	Element	Quantity	Description
1.	Sash equipped with glazing unit, frame is base of the window	1	DU8 – passive glazing unit with external glass toughened wider around perimeter and safe internal glass laminated. Multi-chamber PVC profile.
2.	Assembly set	1	
3.	Profiles mounting roofing	4	Profiles mechanically mounting roofing to the frame
4.	Remote control	1	ZRH12 multi-channel remote control compatible with Z-Wave system
5.	Servo-motor	2*	ZWS12 servo-motor, power voltage 15V, compatible with Z-Wave system, maximum sash tilt: 150mm * for sizes from 120x120
6.	Supply unit	1	ZZ60h supply unit
7.	Rain sensor	1	

III. SIZES

There are available 9 standard sizes. It is possible to manufacture any size from the range given in the table below.

		Window width A= from 60 to 120 cm								
		60	70	80	90	100	110	120	130	140
Window height B = from 60 to 150 cm	60	0,23								
	70		0,33							
	80			0,46						
	90	0,37			0,6					
	100					0,77				
	110									
	120						0,83		1,16	
	130									
	140									
150							1,21			
160										

-size possible to manufacture
 -size not possible to manufacture
 0,23 -effective glazing area, standard size

V. DECLARATION OF PERFORMANCE

Harmonized standard for the product	Marking	Declaration of Performance No.
EN14351-1:2006 +A2:2016	CE	R80/CPR/14351/xx*

* - declaration's release year, eg. R80/CPR/14351/17 released in 2017

VI. ASSEMBLY INFORMATION

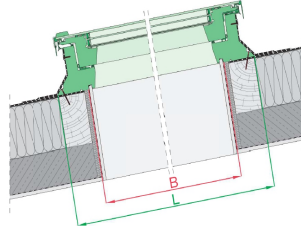
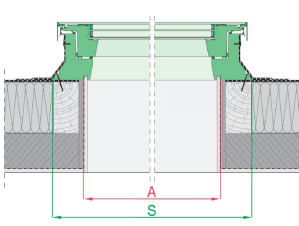

Window commercial size is an opening size in the roof (size A, B). Tolerance of the opening dimensions within +5 cm per side is possible.

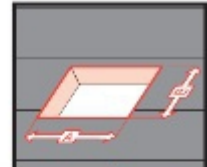

DEF	A	B
[cm]	[cm]	
60x60	60-65	60-65
60x90	60-65	90-95
70x70	70-75	70-75
80x80	80-85	80-85
90x90	90-95	90-95
90x120	90-95	120-125
100x100	100-105	100-105
120x120	120-125	120-125
100x150	100-105	150-155

Do not heat up PVC profiles

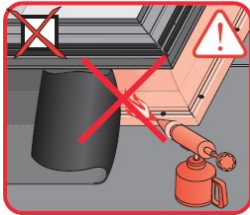

VII. DETAILED SIZES

Window size	Size symbol	Frame external size	Distance between lining grooves	Glazing size	Height
		S x L	p x q	j x k	
[cm]		[mm]			
60 x 60	01K	820 x 820	558 x 558	476 x 476	191
60 x 90	02K	820 x 1120	558 x 858	476 x 776	191
70 x 70	03K	920 x 920	658 x 658	576 x 576	191
80 x 80	04K	1020 x 1020	758 x 758	676 x 676	191
90 x 90	05K	1120 x 1120	858 x 858	776 x 776	191
90 x 120	06K	1120 x 1420	858 x 1158	776 x 1076	191
100 x 100	07K	1220 x 1220	958 x 958	876 x 876	191
120 x 120	08K	1420 x 1420	1158 x 1158	1076 x 1076	191
100 x 150	10K	1220 x 1720	958 x 1458	876 x 1376	191

