

Profile 6 two piece ridges installation guide

01

Introduction

Profile 6 two piece adjustable ridges can be used on roof pitches from 10° to 45°. The ridges have a cover width of 1016mm to match the Profile 6 sheeting, and are fixed through the sheets into the top purlin. There are 4 types of two piece ridge:

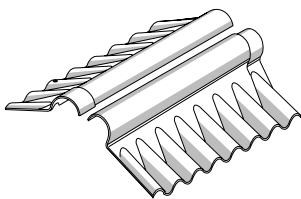

2 Piece Close Fitting Ridge
i.e. with a profiled base.

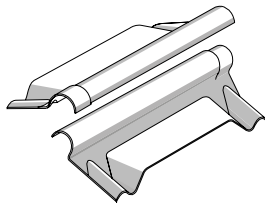

2 Piece Ventilating Ridge
Can be used continuously or together with close fitting ridges. If used continuously, a pair of close fitting ridges should be used at each end of the run in case the last ridge needs to be cut to length.

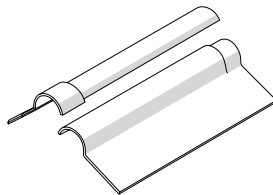

2 Piece Plain Wing Ridge
Sits across the tops of the corrugations.

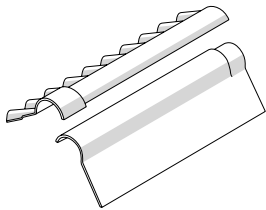

2 Piece Northlight Ridge
Uses the inner roll of the 2 piece plain wing ridge and the outer roll of the 2 piece close fitting ridge. It is now mainly used on monopitch roofs.

02

Position of purlins

The sheets on each slope should be fixed to allow at least 200mm lap with the ridge. The position of the top purlins should be established by using the table shown.

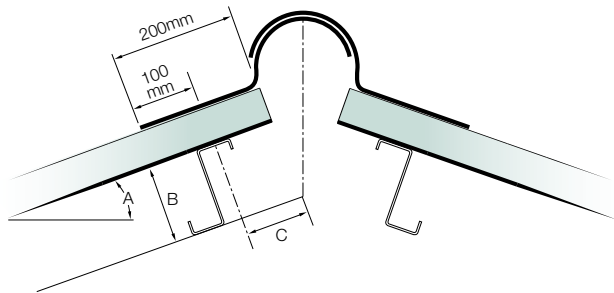

Dimension C for 2 piece ridges

Pitch (A)	Purlin Depth (B)			
	75mm	125mm	175mm	225mm
10°	152	143	134	125
12.5°	146	135	124	113
15°	140	127	113	100
17.5°	134	118	102	87
22.5°	121	100	80	59
30°	100	71	42	–

Position of two piece ridges

03

When positioning the 2 piece close fitting ridges, if the small roll of the ridge is laid on the slope sheeted left to right and the large roll is laid on the slope sheeted right to left, the laps of the ridge will align with the laps of the sheets.

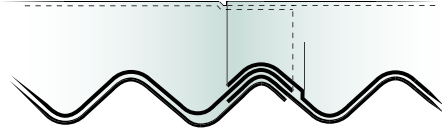

Sheeting left to right, small roll of ridge

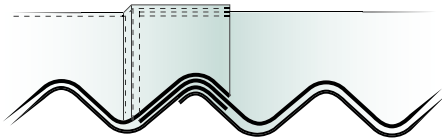

Sheeting right to left, large roll of ridge

If the small roll of the ridge is laid on the slope sheeted right to left and the large roll is on the slope sheeted left to right, the lap of the ridge must be offset 1 corrugation from the lap of the sheets.

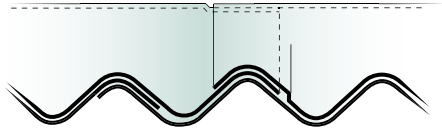

Sheeting right to left, small roll of ridge

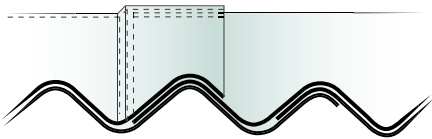

Sheeting left to right, large roll of ridge

Where lap sealants are required for the sheeting, the sealant should also be applied to the 2 piece close fitting and 2 piece northlight ridges.

Finials

04

Finials are used to finish the ridge at each end of the building. Disc finials are used in conjunction with plain wing bargeboards or where bargeboards are not being used, and 2 piece hooded finials are used in conjunction with roll top bargeboards.

The finials fit best onto the main body of the ridge, not on the socketed end, so it may be preferable to offset the ridges as described in section 3.

The disc finials should be seam bolted to the inner roll of the ridge before fitting the outer roll.

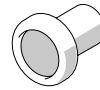

Disc type ridge finial

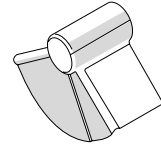

Hooded two piece ridge finial

To suit roll top barge boards